

1	Revision content description	2	Date	3
1	First Issue		2021-09-17	

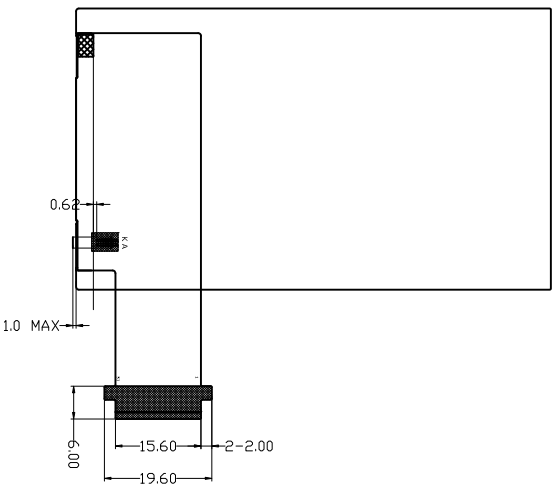
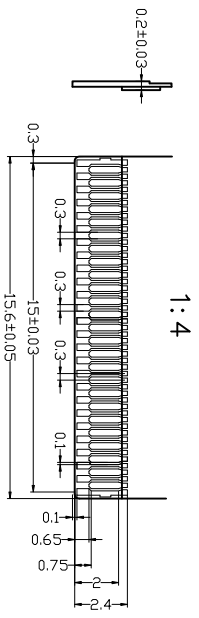
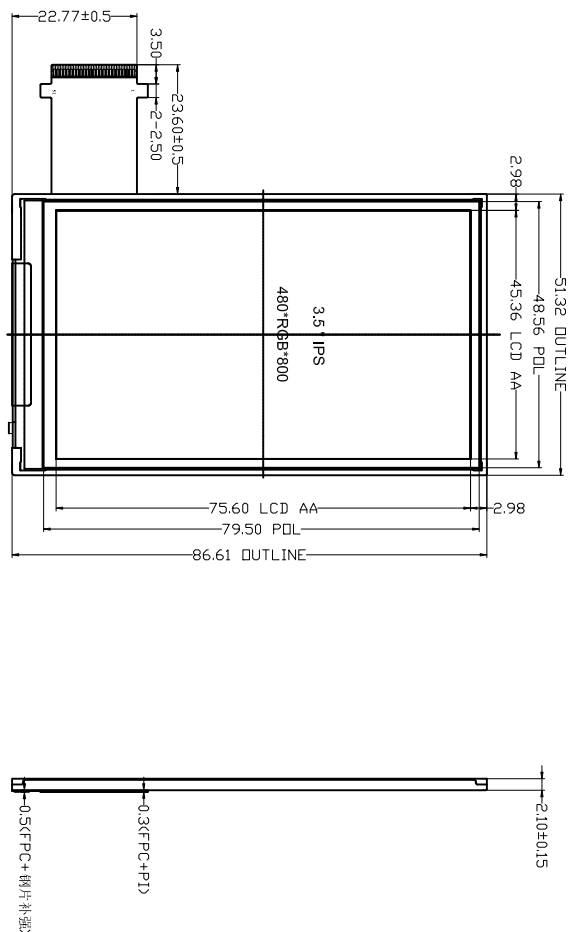

NO.	SYMBOL
1	LED-K
2	LED-A
3	VI/NC
4	XI/NC
5	VI/NC
6	XR/NC
7	GND
8	VCI/2.8
9	NC
10	10VCC/L.8
11	NC1
12	S00
13	SD1
14	SCL
15	CS
16	RSET
17	D23 (R0)
18	D22 (R1)
19	D21 (R2)
20	D20 (R3)
21	D19 (R4)
22	D18 (R5)
23	D17 (R6)
24	D16 (R7)
25	D15 (G0)
26	D14 (G1)
27	D13 (G2)
28	D12 (G3)
29	D11 (G4)
30	D10 (G5)
31	D09 (G6)
32	D08 (G7)
33	D07 (B0)
34	D06 (B1)
35	D05 (B2)
36	D04 (B3)
37	D03 (B4)
38	D02 (B5)
39	D01 (B6)
40	D00 (B7)
41	ENABLE
42	DOTCLK
43	HSYNC
44	VSYNC
45	NC
46	NC
47	NC
48	NC
49	NC
50	NC
51	GND

NOTES:

1. DISPLAY MODE: 3.5" TFT LCD
2. DRIVER IC: SC7798
3. VIEWING DIRECTION: ALL
4. BACKLIGHT: VF=22.4V, IF=20mA
5. OPERATING TEMPERATURE: -20° C TO 70° C
6. STORAGE TEMPERATURE: -30° C TO 80° C
7. GENERAL TOLERANCE: ±0.20

LED A LED K

IF = 20mA, VF = 22.4V

CUSTOMER APPROVE

深圳市弘盛智能科技有限公司
HONSEN SHENZHEN HONSEN SMART DISPLAY TECHNOLOGY CO., LTD

LCD MODULE	PRODUCT NO.	FILE NAME	REV
	G03SHS11T32N	LCM	V0

TOLERANCE: DECIMAL	DESIGNED: ZMY	CHECKED:
X.X ± .30	VERIFIED:	APPROVED:
X.XX ± .20	NOT IN SCALE	UNIT:mm
ANG ± 1/4°		SHEET: 1/1